

# INTEGRAL ELECTRONICS (IEPE) PIEZOELECTRIC ACCELEROMETER

## MODEL 2008A

- Outstanding Dynamic Range
- Wide Bandwidth
- Low Impedance Output
- Top Connector
- Stud Mounted



### Description

The VIP Sensors Model 2008A is a stud mounted piezoelectric accelerometer designed for shock measurements on structures and objects. It features a high signal-to-noise ratio, a high output sensitivity, and a wide bandwidth. The accelerometer transmits its low impedance voltage output through the same cable that supplies the constant current power.

The Model 2008A design is sealed against external contamination. Signal ground is connected to the outer case of the unit. When used with an isolated mounting stud, the accelerometer is electrically isolated from ground. The accelerometer features a 10-32 top connector that is used with coaxial cable for error-free operation.

VIP Sensors Signal Conditioner Models 5005, 5100 and 5102 are recommended for use with this low impedance accelerometer.

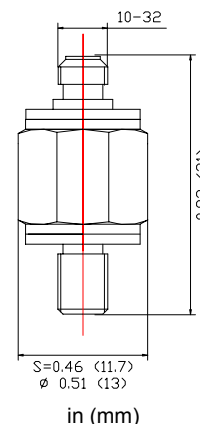

Typical Amplitude Response

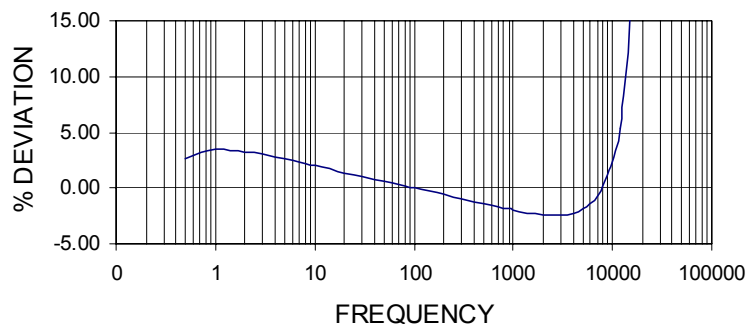

Typical Temperature Response

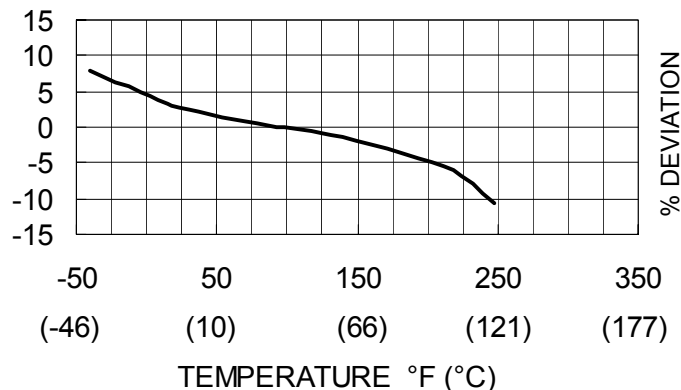

# INTEGRAL ELECTRONICS (IEPE) PIEZOELECTRIC ACCELEROMETER

# MODEL 2008A

## SPECIFICATIONS

The following performance specifications conform to ISA-RP-37.2 (1964) and are typical values, referenced at +75°F (+24°C) and 100 Hz, unless otherwise noted. Calibration data, traceable to National Institute of Standards and Technology (NIST), is supplied.

	UNITS	
<b>DYNAMIC CHARACTERISTICS</b>		
Range	g (m/s <sup>2</sup> )	5,000 (49,033.3)
Voltage Sensitivity, typical	mV/g (mV/m/s <sup>2</sup> )	1.0 (0.1)
Transverse Sensitivity	%	≤ 5
Frequency Response		See Typical Amplitude Response
Resonance Frequency	Hz	40,000
Amplitude Response		
± 5 %	Hz	1 – 8,000
± 1 dB	Hz	1 – 10,000
Temperature Response		See Typical Temperature Response
Amplitude Linearity	%	< 1
<b>ELECTRICAL CHARACTERISTICS</b>		
Output Polarity		Acceleration directed from base into the transducer defined as positive
Power Source Voltage (Constant Current)	VDC	+18 to +28
Supply Current	mA	2 to 10
Bias Voltage	V	11±1
Full Scale Output Voltage (peak)	Vp	≤ 5
Output Impedance	Ω	< 100
Noise	mg (mm/s <sup>2</sup> )	< 8 (< 78.4)
Grounding		Signal ground connected to case
<b>ENVIRONMENTAL CHARACTERISTICS</b>		
Temperature Range		-40°F to 248°F (-40°C to +120°C)
Humidity		Epoxy sealed
Shock Limit	g pk (m/s <sup>2</sup> pk)	5,000 (49,033.3)
Base Strain	equiv. g /μstrain	5mg/με
Magnetic Field Sensitivity	equiv. g rms /gauss (T)	0.5g/T
Thermal Transient Sensitivity	equiv. g /°C	4mg (3Hz)
<b>PHYSICAL CHARACTERISTICS</b>		
Weight	oz (grams)	0.28 (8)
Case Material		Stainless Steel
Mounting		10-32, torque 2 N-m (18 lbf-in)
Piezoelectric Material		PZT-5
Structure		Shear
Output Connector		10-32 receptacle, top mounting

### ACCESSORIES

**Included:**

9005L10 Coaxial Cable 10-32/BNC, 10ft (3.3 m)  
 9504-8 10-32/10-32 Mounting Stud  
 Calibration Sheet

**Optional:**

9006L10 Coaxial Cable 10-32/10-32, 10 ft (3.3 m)  
 9505-8 10-32/10-32 Isolated Mounting Stud  
 9505-11 10-32/Isolated Adhesive Mounting Plate

### NOTES

- Short duration shock pulses, such as those generated by metal-to-metal impacts, may excite transducer resonance and cause linearity errors.